

EMU POINT - ESTUARY

Existing Condition



- Activities**
- Limited diversity in play/exercise opportunities.
 - No dog access currently allowed.
- Amenities**
- Lack of sheltered BBQ/tables/seating/potable water - require shade, shelter and improved spatial arrangement.
- Access**
- No continuous formal pedestrian access exists through the main area.
 - Current access is to beach via stairs only.
 - No continuous cycle way connects recreational areas.
- Natural Environment**
- Eucalypts are in poor health - option for tree replacement strategy to replace poor quality trees.
 - High tides currently causing erosion and degradation to walls.
- Vehicular Movement + Parking**
- Limited parking during peak times - contributing to issues with informal parking and safety of park users.
 - Vehicle access to beach currently accommodated at Swarbrick end from marina. Potential to cause conflict between user groups and degradation to natural environment.

Design Principles

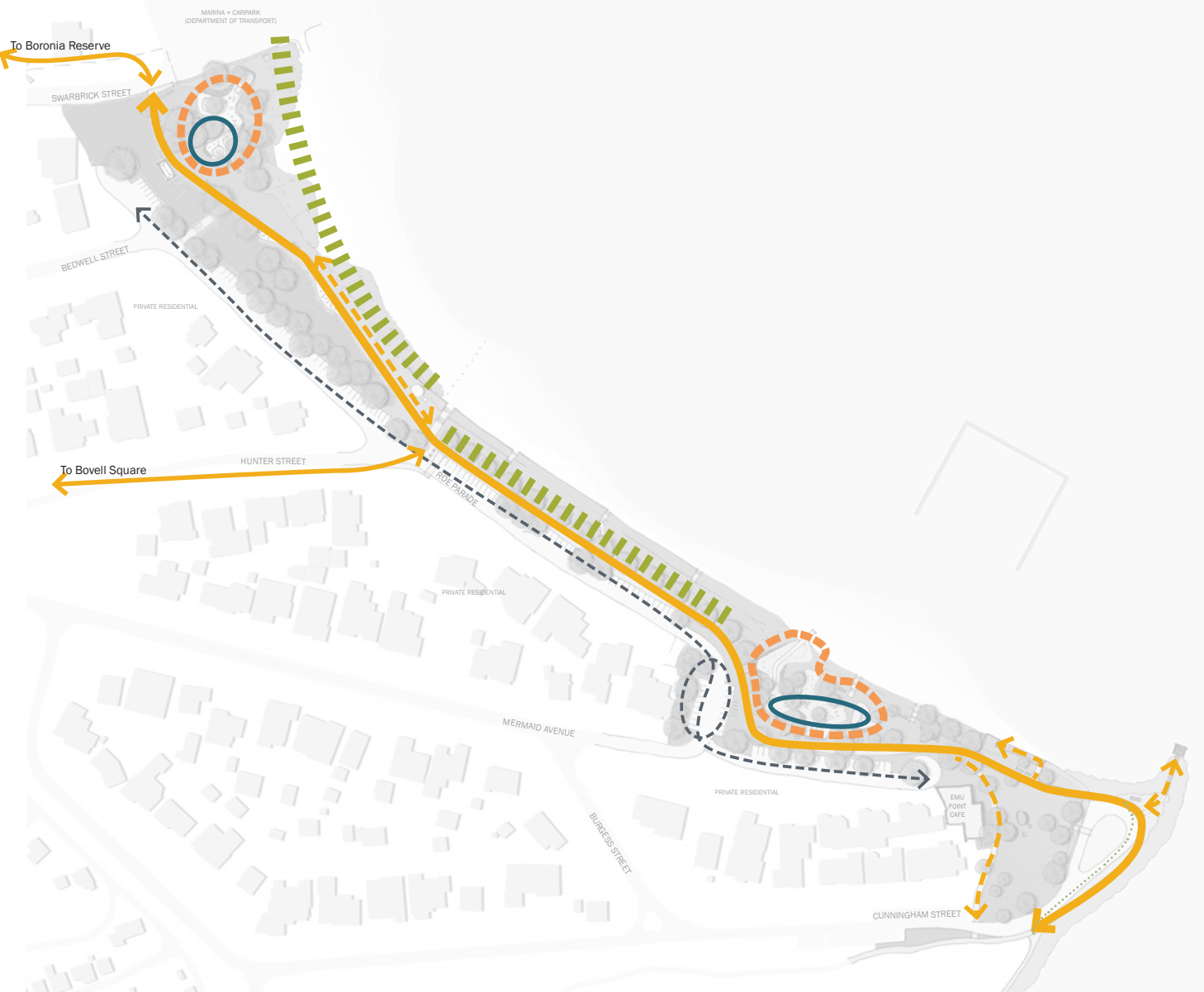

Staging + Implementation

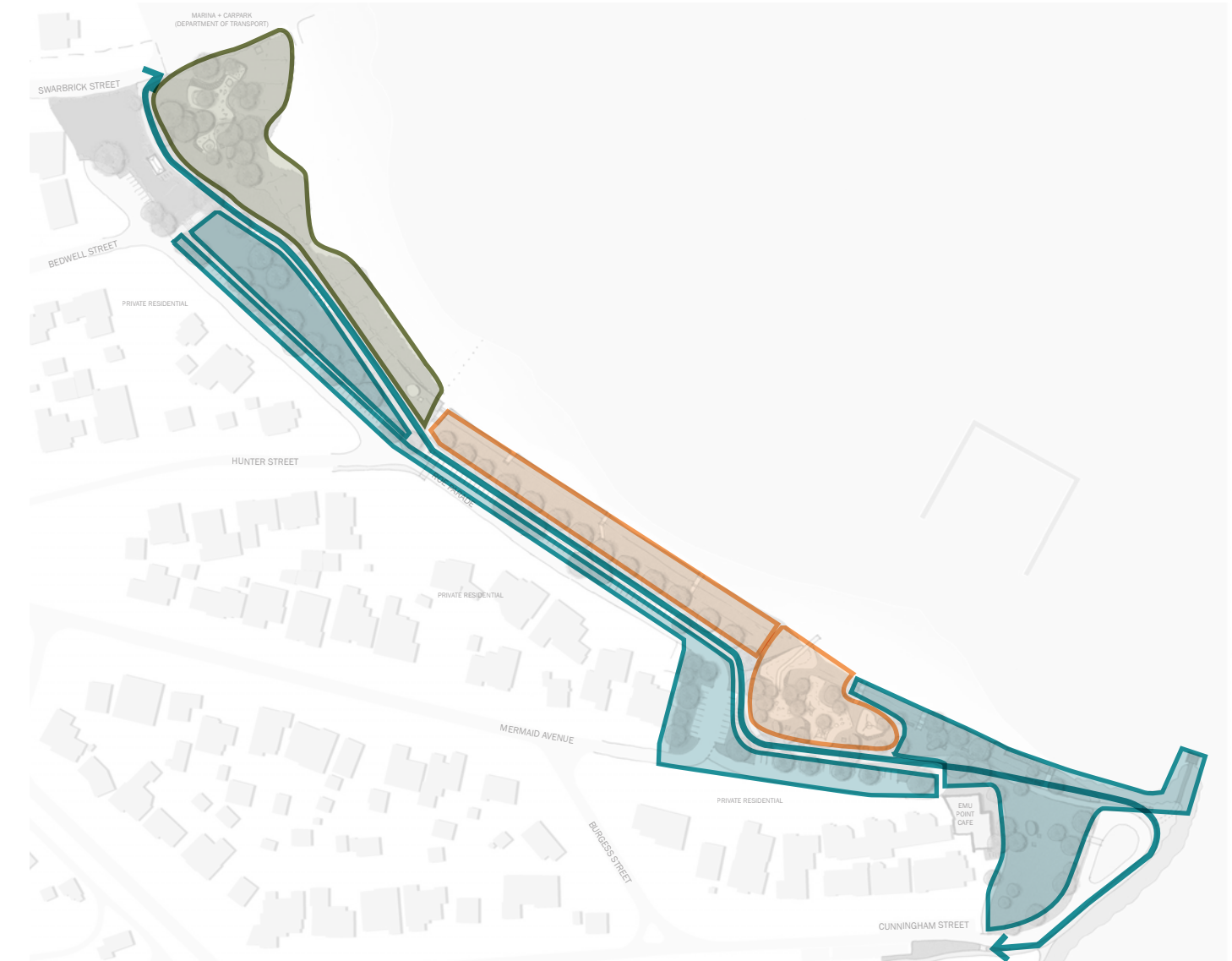

Recommendations



EMU POINT - OCEAN

Existing Condition



- Activities**
- Underutilised and disconnected "Local" park.
 - Limited diversity in recreational opportunities. No sense of place or defining character to Firth St end.
- Amenities**
- BBQ/tables/seating/potable water. Requires shade, shelter and improved spatial arrangement. Seating/shelter required at Firth St and along path.
 - Poor interpretation of area and wayfinding along cycleway.
 - More dog facilities required.
- Access**
- Shared Use Path (SUP) is currently incomplete and terminates at Cunningham St - connections required to existing network.
 - No formalised pedestrian access to adjacent residential areas.
 - Limited universally accessible access to beach/groyne.
- Natural Environment**
- Limited shade trees to parking areas (contributes to users parking on adjacent private verges).
 - Overgrown vegetation restricts views from recreational areas to coast.
 - Large areas of non-reticulated lawn, with weed encroachment, potentially suffering from salt spray and does not contribute to coastal identity.
 - Extremely exposed location, erosion occurring to coastline.
- Vehicular Movement + Parking**
- Informal parking during peak times impacts on neighbouring properties. Parking occurs on private verges where shade can be found. Bollards incorrectly located causing overhang onto road.

Design Principles



- Destination Creation**
- Provide improved diversity in recreational spaces by providing new defined play spaces that respond to the coastal character and enhanced picnic, viewing and exercise nodes.
- Connectivity**
- Provide extension and connections to existing pedestrian and cycle ways to provide linkage between destinations. Provide respite areas to pause along the path network, with wayfinding, interpretation and improved shelter from the weather.
- Accessibility**
- Maintain universal access ramps to beach and provide new access points to the groyne.
- Comfort and Amenity**
- Provide improved picnic nodes with enhanced vegetation to define and shelter the areas. Provide new shelters, picnic facilities and seating that are orientated well to protect from the elements, maximise use of tree canopy cover and are in close proximity to path network and beach access points. Ensure materiality and design is simple, robust to tolerate wear and tear, and strengthens the coastal character.
- Environmental Enhancement**
- Enhance coastal dune vegetation to assist ongoing coastal erosion mitigation, to define and shelter recreational nodes and strengthen coastal character. Provide new tree planting strategy to increase shade, comfort and canopy cover to hard stand parking areas.
- Vehicle Management**
- Formalise parking to increase capacity and improve use of recreational spaces.

Staging + Implementation



- SHORT Stage 1: SUP Amenities, Parking + Vegetation Management**
- Improved interpretive/exercise/viewing nodes along Shared Use Path (SUP)
 - Enhanced vegetation to shelter interpretive/exercise/viewing nodes
 - Formalised parking with shade
 - Vegetation management to foredunes
- MEDIUM Stage 2: Playground + Picnic Facility Upgrades + Access Upgrades**
- Cunningham St picnic + grassed area upgrades (inc. New facilities and vegetation management to picnic nodes)
 - All ages local play space
 - Footpath connections to SUP
 - Fishing platform to groyne
 - Firth St new picnic + grassed area (inc. New facilities)
- LONG Stage 3: Firth St Public Open Space**
- Boongarie St road realignment and enhanced POS
 - Firth St Informal nature play

Recommendations



Recommendations

- Activities**
- 01 Consider realigning Boongarie St to improve connection between open space, coast, and Shared Use Path (SUP) to create destination. Future development of POS to be further considered following review of coastal processes study and long term zoning and redevelopment plans.
 - 02 Create 'dunal landscape' - informal nature play/trike track as deviation off main cycle way. Consider a "Learn to Ride" track.
 - 03 Provide local scale play space at Cunningham St picnic node. Include all ages climbing structure catering to both teenagers and smaller children.
 - 04 Integrate exercise nodes along pathway. Ensure locations are resolved in conjunction with wider recreational strategies and cycle strategy.
- Amenities**
- 05 Create new sheltered picnic node with seating and shelter adjacent to shared use path at Firth St. Consider inclusion of informal nature play elements.
 - 06 Create consolidated picnic nodes along Cunningham St with improved picnic shelters and settings. Reduce open turf areas and define and shelter picnic areas with low coastal dune vegetation.
 - 07 Improve signage and amenities to create interpretive node and rest stop at Firth St threshold to coastal path and transition from coastal path to developed reserves.
 - 08 Provide regular seating and viewing nodes to pathway, with additional shade trees.
 - 09 Provide bicycle and bin nodes at entrances to parks and along pathway.
 - 10 Consider extending dog exercise area up to Firth St and provide additional doggy bag stations/bins and water tap along Shared Use Path.
 - 11 Install low level solar lighting to pathways.
 - 12 Install lighting to play spaces to increase safety and extend use into the evening.
- Access**
- 13 Connections required through to Emu Point to complete the highly valued Coastal Shared Use Path (SUP) network. Extend and connect existing SUP and footpaths to provide safe accessible route.
 - 14 Consider adjoining footpath connections - provide footpath along Firth St connecting to existing Shared Use Path.
 - 15 Consider universally accessible boardwalk and fishing platform along groyne.
- Natural Environment**
- 16 Provide additional shade trees (peppermints) to parking areas.
 - 17 Implement vegetation management strategy to maintain views.
 - 18 Replace select areas of turf with low coastal dune vegetation.
 - 19 Consolidate access tracks and revegetate to protect dune vegetation. Continue ongoing vegetation management to foredune areas for weed control, to reduce informal access, and address erosion.
- Vehicular Movement + Parking**
- 20 Formalise verge parking and relocate bollards to appropriate distance off kerb line. Group and define bays with new peppermint trees for shade.

MIDDLETON BEACH + ELLEN COVE

Existing Condition



Activities

- Limited diversity in play experience and age appropriate play opportunities.
- Large open grassed areas required for passive recreation.
- Limited area for passive recreation to S/E of 3 anchors. Area in front of amphitheatre gets extremely full during events.
- Strong desire from community for more age diverse exercise equipment.
- Limited variety in food/beverage retailers

Amenities

- BBQ/tables/seating/potable water - requirement for shade, shelter and improved spatial arrangement.
- No large shelters currently cater for big groups.

Access

- Current access to beach is a safety issue and no universal access is provided.
- Surf Club perimeter treatment does not encourage integration of activities with POS and there are issues with sand/mud and wear and tear on turf.
- Approach to lookout is poorly integrated with surrounding POS and stairs are due for upgrades.
- Stairs to Ellen Cove Amphitheatre are a safety risk and need addressing to meet appropriate standards.

Natural Environment

- Norfolk Island Pine needles contribute to high maintenance requirement and provide excessive shade to grass.
- Turf uneven due to sand drift. Requires ongoing maintenance and contributes to access constraints.
- Ongoing weed management and revegetation required to address coastal erosion.
- Weed encroachment between grass and dune vegetation.

Infrastructure

- Retaining wall is in poor condition and unstable in areas.
- Stormwater outlets currently discharge onto beach. Water quality is unknown and drains require regular clearing of sand build up.
- Stairs to amphitheatre are failing.

Vehicular Movement + Parking

- Formalised maintenance/emergency access required.
- Car parking and road network is incoherent and increased capacity may be required in conjunction with Esplanade redevelopment.

Design Principles



Destination Creation

- Provide complementary spaces that enhance the diversity of recreational opportunities by providing new imaginative and interactive contextually themed and age appropriate play spaces, large open grassed events spaces, exercise nodes, and picnic facilities that are well connected to the beach, cafe, access routes and parking.

Connectivity

- Provide new boardwalk to beachfront, connecting recreational spaces, allowing access to beach and assisting in management of sand drift. Ensure the boardwalk is generous width to allow pedestrian and cycle way access, well lit, has bike racks at connections and offers opportunity for seating and interpretation along its length.

Accessibility

- Provide regular universal access points to beach from the boardwalk and connected hard paved areas between path network and boardwalk to facilitate ease of movement between spaces.

Comfort and Amenity

- Provide improved picnic nodes with new large grouped shelters and picnic facilities, well connected to amenity infrastructure and open recreational areas and play spaces. Ensure materiality and design is simple, robust to tolerate wear and tear and strengthens the coastal character.

Environmental Enhancement

- Maintain and enhance coastal dune vegetation, close off select beach access paths and create improved open grassed areas.

Vehicle Management

- Formalise maintenance access and consolidate in hard stand area and to reduce conflict with open recreational and play areas.

Staging + Implementation

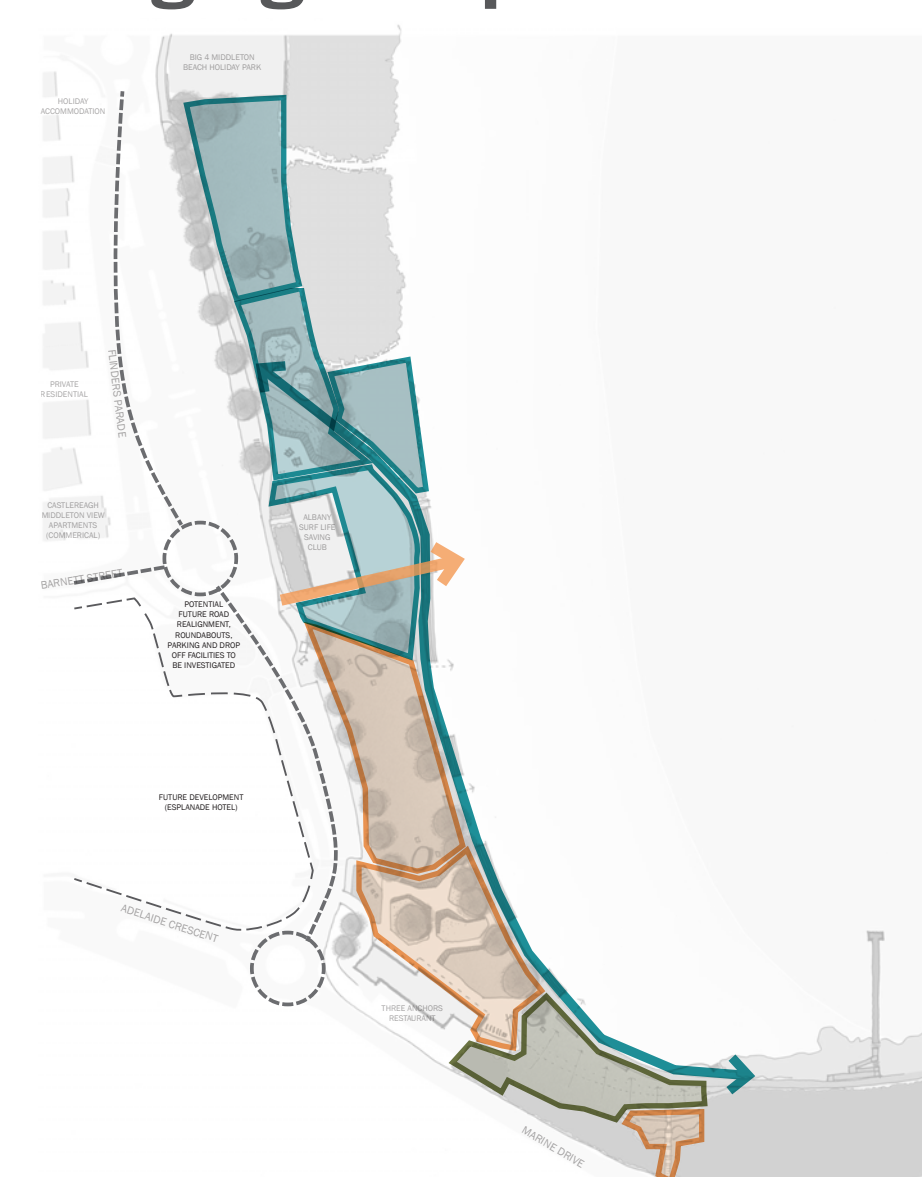

SHORT

- Stage 1: Playground, Picnic Facility Upgrades + Access Upgrades**
- All ages sculptural play space
 - Picnic + grassed area upgrades (inc. New facilities)
 - New maintenance and emergency access
 - Amphitheatre upgrades

MEDIUM

- Stage 2: Boardwalk, Events Space + Beach Access**
- New boardwalk, beach access stairs + ramps
 - Surf club integration, hard paved events space
 - New lookout
 - New youth activity zone
 - Picnic + grassed area upgrades (inc. New facilities)

LONG

- Stage 3: Enlarged Passive Recreation Space**
- Enlarged and regraded sloped lawn to Ellen Cove and associated picnic facilities

Recommendations



Recommendations

Activities

- Create youth focused activity zone to north of surf club. Playspace design to respond to coastal character and improve integration with surf club. Consider integrated climbing wall to improve integration with level change to lookout and to act as wind buffer to S/E prevailing winds.
- Create regional sculptural and interactive playspace for all ages in front of 3 Anchors kiosk. Consider theme of whales (Indigenous stories) and maritime history.
- Retain large open grassed areas for passive recreation and events.
- Enhance and enlarge open grassed area adjacent to amphitheatre as sloped lawn. (Remove existing section of Shared Use Path and provide alternative access along proposed boardwalk.)
- Include exercise equipment nodes along pathway.
- Consider long term integration of volleyball nets into beach landscape with boardwalk terracing to function as informal seating.
- Investigate feasibility for temporary food and beverage vans (pop-up stalls). Develop programming strategy for peak season/holiday periods.

Amenities

- Provide new large picnic shelters to accommodate larger groups/gatherings. Locate amenities in consolidated groups i.e. picnic shelters, settings and BBQs close to existing trees and play area. Include replacement strategy for furniture with an updated suite of typologies and materials.
- Locate outdoor showers and bike racks adjacent to surf club in hard paved areas.
- Replace tables and chairs in amphitheatre with an updated suite of typologies and materials.
- Provide bicycle and bin nodes at entrances to park and at regular points along pathways.
- Provide regular integrated bench seating along boardwalk. Incorporate strategy for sponsored seats in form of plaques/routing or similar integrated artwork into bench seating.
- Install low level solar lighting to pathways.
- Install lighting to youth activities area and play spaces to increase safety and extend use into the evening.

Access

- Create wide boardwalk promenade along edge of grass/retaining wall to improve access along beach front and facilitate improved management of sand drift. Integrate wide stepped and ramped terraces to function as seating and universal access points to beach. Ensure "Share the Path" signage is incorporated.
- Upgrade area around surf club and improve integration with POS, including new ground treatment and access around perimeter. Create larger hard paved area for multifunction events space, showers, seating and bike racks. Hardstand to accommodate maintenance/emergency vehicle access.
- Improve access to lookout and upgrade viewing platform with integrated seating and signage.
- Upgrade amphitheatre central stairs to safe and accessible standard. Incorporate additional steps as required to reduce riser.

Natural Environment

- Norfolk Island Pines provide heritage value and character of place - intention is to retain and protect all healthy trees.
- Consider minor regrading of existing turf in conjunction with implementation of proposed boardwalk to create smoother surface and eliminate trip hazards.
- Ongoing vegetation and weed control required to foreshore coastal vegetation. Reduce informal access to beach and consolidate beach access paths.
- Separation required between turf and dune vegetation. Consider installing hard edge from caravan park to lookout to replace post and rail fence.

Infrastructure

- Incorporate remedial works/removal and replacement to existing wall as required in conjunction with proposed boardwalk structure.
- Improve visual and environmental impact of stormwater outlets. Consider upstream treatment of stormwater. Investigate potential for diversion of flow prior to exiting at beach and inclusion of GPT or similar integrated under boardwalk structure.
- Replace and upgrade stepped access to standards. Close access to and remove unsafe stairs to east of amphitheatre.

Vehicular Movement + Parking

- Provide hard paved area to accommodate maintenance/emergency access adjacent to surf club.
- Current car parking and road network to be further investigated in conjunction with development of Esplanade site. Road realignment, roundabouts and improved drop off zones to be considered to improve legibility and safety.

EYRE PARK

Existing Condition



Activities

- Limited diversity, age appropriateness and accessibility of current play equipment. Play equipment is disconnected with no cohesion or integration with wider park.
- Large areas of open grass that are fragmented and underutilised.

Amenities

- Lack of shelters/ picnic facilities dispersed across the park. Existing shelter is well used, particularly for events however additional capacity is required.
- No wayfinding or interpretive signage exists regarding the site or wider area.
- Additional seating, bins, bike racks required across the park.
- Access to and interaction with lake is limited by narrow bridge and steep edges.
- Toilets require refurbishment.

Access

- Currently no continuous formal pedestrian and cycle access is in place around park or connecting to adjacent areas.

Natural Environment

- Numerous memorial trees are in poor health or poorly located.
- Existing irrigation lake offers minimal ecological value, and is poorly integrated into park. Edge condition presents a safety risk.
- Large areas of open grass that are fragmented and underutilised.

Infrastructure

- Bowling club is currently poorly connected and integrated into park setting.

Vehicular Movement + Parking

- Additional carparking required. Current carpark gets very full, particularly during events.
- Adelaide Crescent currently used as thoroughfare and high traffic volumes/ speeds present conflict and safety concerns with park users and local residents.

Design Principles



Destination Creation

- Provide complementary spaces that enhance the diversity of recreational opportunities by providing new imaginative and interactive contextually themed all abilities play space and youth activities, large open grassed events spaces, and picnic facilities that are well connected to the lake, access routes and parking.

Connectivity

- Provide safe continuous pedestrian and cycle way defined from internal park network connecting park to adjacent path networks.

Accessibility

- Provide additional internal path connections allowing universal access between recreational spaces and interaction with lake.

Comfort and Amenity

- Provide improved picnic nodes with new large shelters and picnic facilities, well connected to open recreational areas, play spaces and parking. Ensure materiality and design is simple, robust to tolerate wear and tear and strengthens the park character.

Environmental Enhancement

- Enhance ecology, habitat creation, visual amenity and safety of lake edge. Rationalise and reduce underutilised grass areas and enclose and buffer with native vegetation to road edges.

Vehicle Management

- Formalise and increase carpark capacity, located to support enhanced play spaces. Improve safety and amenity of residents and park users through traffic calming to Adelaide Crescent.

Staging + Implementation

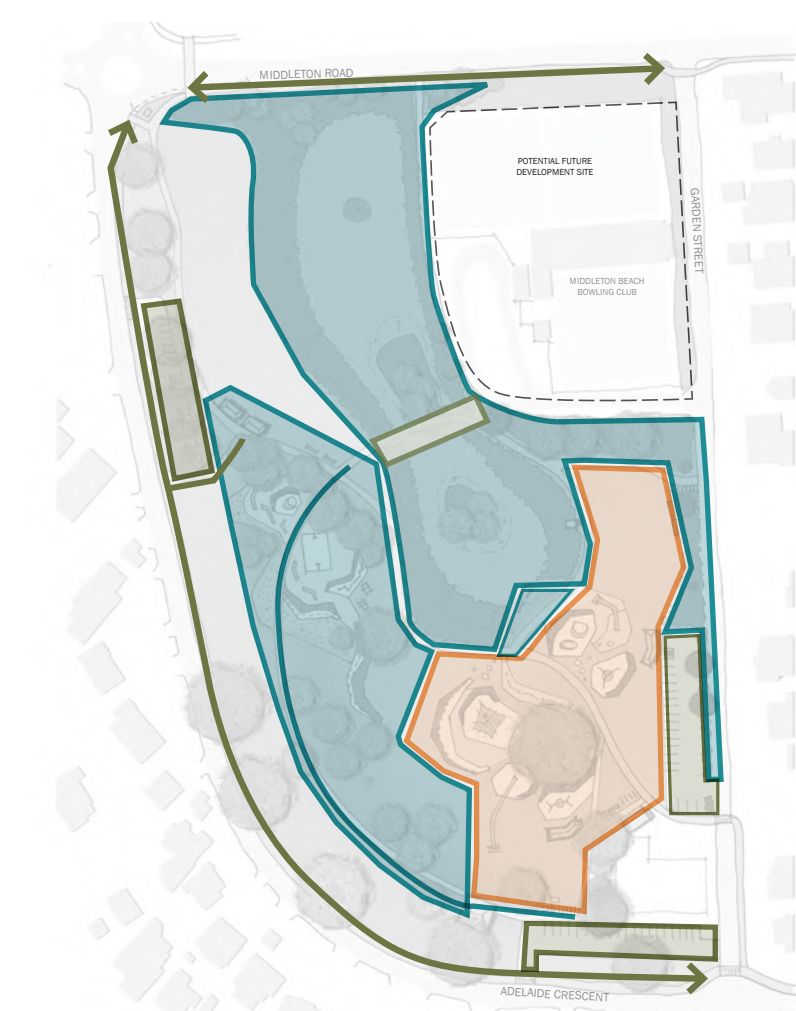

SHORT

- Stage 1: All Abilities Playground + Picnic Facility Upgrades**
- All abilities play space
 - Picnic + grassed area upgrades (inc. New facilities)

MEDIUM

- Stage 2: Youth Activity Area, Lake Enhancements + Revegetation**
- Upgraded youth activity zone (inc. New picnic facilities)
 - Improved footpath connections
 - Memorial tree replacement + relocation
 - Regrading and revegetating to lake edge and park perimeter
 - Lake edge viewing platform

LONG

- Stage 3: Pedestrian + Vehicle Access Improvements**
- Upgraded and enlarged carparks
 - Additional perimeter footpath connections
 - New lake bridge crossing
 - Shared Use Path to Adelaide Crescent

Recommendations



Recommendations

Activities

- Create centralised all abilities play area with improved integration to park, adjacent to path network, parking and picnic facilities. Locate play area around central feature willow tree.
- Enhance youth focused activity area around existing basketball hoop. Utilise slope and topography to create moulded landscape incorporating climbing walls, skateable elements and ping pong.
- Rationalise and improve functionality of open grassed areas to provide active zoning and complement play areas, facilitate for events and allow passive recreation.
- Consider feasibility to develop existing pathway as a "learn to ride" park.
- Investigate feasibility for temporary food and beverage vans (pop-up stalls).

Amenities

- Provide additional picnic facilities with shelters adjacent to parking, play, and events space to encourage and accommodate activity across the park. Locate amenities in consolidated groups i.e. picnic shelters, settings and BBQs close to existing trees and play area.
- Incorporate entrance/wayfinding signage at key junctions into park and interpretive signage/integrated interpretive art elements within park.
- Provide additional bike/bin facilities along pathway at key entrances.
- Provide additional seating along pathway under shade of existing trees and with views over lake.
- Provide viewing deck to lake and integrate interpretation and seating close to play area.
- Replace existing bridge with wider bridge with integrated seating and interpretation.
- Refurbish existing toilets and ensure toilets are DDA compliant.
- Install low level solar lighting to pathways.
- Install lighting to youth activities area and play spaces to increase safety and extend use into the evening.

Access

- Provide SUP to perimeter of park to connect with existing footpaths and greater cycle strategy.
- Provide additional path connections within park to improve circulation and universal access between carparks, play spaces, and lake.
- Provide safe legible connections with appropriate wayfinding and interpretation to assist in movement between Eyre Park, Lake Seppings and Middleton Beach.

Natural Environment

- Relocate healthy memorial trees to create shaded groves of trees on embankment.
- Reassess arborist report and remove trees in poor health.
- Regrade and revegetate lake edge and islands to enhance ecological value. Improve safety and restrict access to water body with vegetated zone (minimum 1:6 grade to water).
- Enhance and extend revegetated areas to create buffer to roads.
- Reduce underutilised areas of grass and replace with native vegetation to increase ecological value and minimise reticulation demand.

Buildings + Infrastructure

- Improve connection between bowling club and park with open permeable fence to increase visual permeability and integration with park.
- Investigate potential to relocate bowling club in long term - potential future development site.

Vehicular Movement + Parking

- Enlarge and resurface main carpark off Adelaide Crescent.
- Relocate and formalise carpark off Garden St. Integrate vegetated swale to road edge.
- Consider extending and resurfacing north west carpark off Adelaide Crescent to accommodate additional parking during events parking.
- Consider road narrowing to local residential width and traffic calming to reduce speeds. Incorporate Shared Use Path to perimeter.

SURFERS' BEACH

Existing Condition Plan



Activities

- Currently well used by dog owners/Granny grommits/surf lessons and whale watching location.

Amenities

- Limited seating/shelter exists.
- Signage poorly located and requires updating.
- Current shower situated in sand with poor drainage.
- Grab rails currently being used as cycle racks.

Access

- No universal access is currently provided to viewing platforms
- Shared use path requires realigning adjacent to beach access to avoid crossing carpark.
- Sand drift occurring and causing access and maintenance issues.

Vehicular Movement + Parking

- Sufficient car parking capacity.

Natural Environment

- Sparse vegetation and large areas of grass contributing to sand drift at entrances.
- Four sand tracks currently exist to beach, south/east tracks poorly aligned and suffer higher erosion.



Staging + Implementation Plan

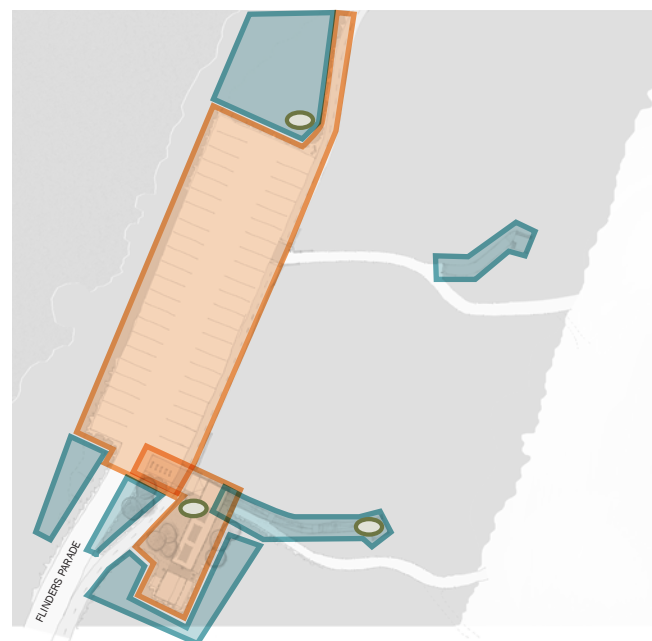

SHORT

Stage 1: SUP Realignment + New Shelter Area

- Realigned Shared Use Path (SUP)
- Retaining wall to manage sand drift
- New shelter, picnic tables and shower upgrades



MEDIUM

Stage 2: Access + Viewing Platforms

- Upgraded universal access to viewing platforms
- Enlarged and improved viewing platforms
- Vegetation enhancements + management



LONG

Stage 3: Interpretation

- Interpretation to viewing platforms + Coastal Path (not costed)

Enhancement Plan

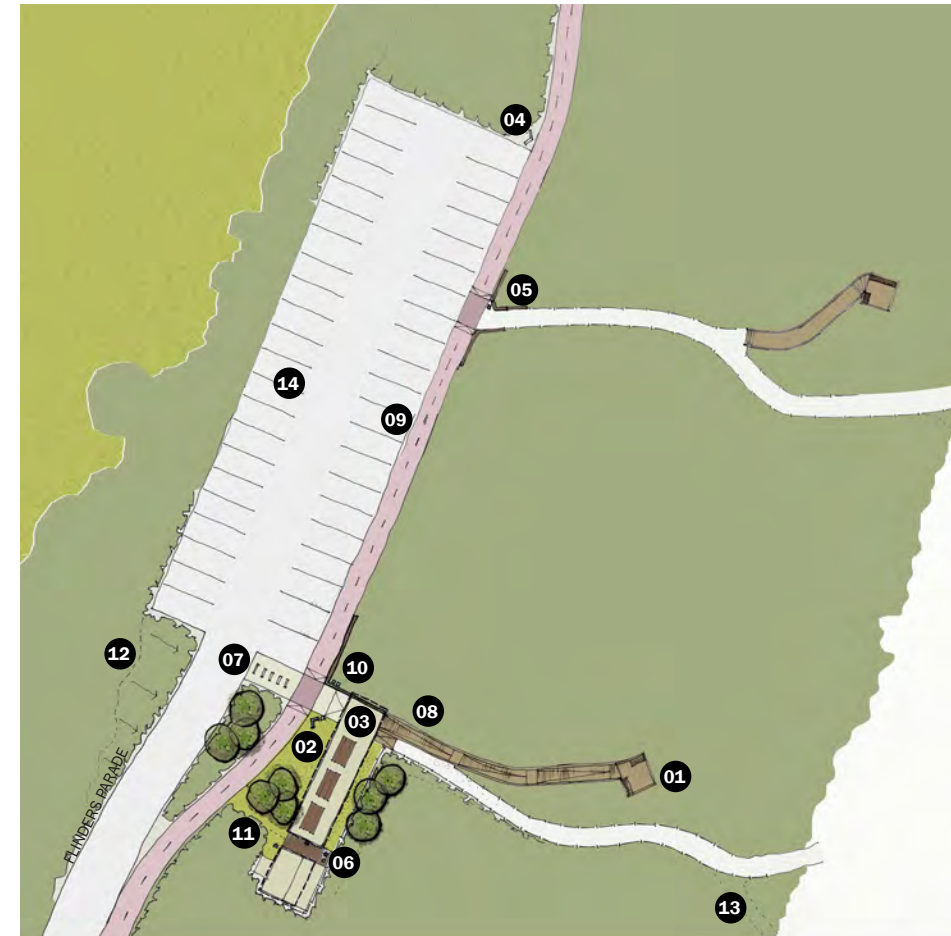

Recommendations

Activities

- 01 Improve facilities for whale watching.
- 02 Improve and enhance location as rest stop and key interpretive node along coastal path network.

Amenities

- 03 Provide large shelter and additional picnic settings undercover.
- 04 Include interpretive signage.
- 05 Improve location and content of wayfinding/etiquette signage at entrances to beach access paths.
- 06 Relocate and provide raised shower platform to improve drainage. Integrate with new shelter and toilets.
- 07 Install new cycle racks in hardstand, easily and safely accessed off Shared Use Path.

Access

- 08 Replace existing access way to southern viewing platform to include universal access. Maintain stepped access to northern viewing platform.
- 09 Realign shared use path to eastern (beach) side of carpark to facilitate continuous access, separated from vehicle traffic and connected to amenities and beach access. Ensure "Share the Path" signage incorporated.
- 10 Install low retaining wall and raised entrance platform to beach access points to reduce sand drift onto path.

Vehicular Movement + Parking

- 14 Maintain existing carpark and install new linemarking following Shared Use Path realignment.

Natural Environment

- 11 Increase vegetation cover up to retaining walls. Revegetate perimeter of shelter/toilet area with low coastal dune vegetation to minimise grass and increase vegetated protection.
- 12 Regrade western embankment and revegetate areas following Shared Use Path realignment.
- 13 Close off two tracks and brush paths. Ensure vegetation is maintained to discourage further access points.