

DRAFT

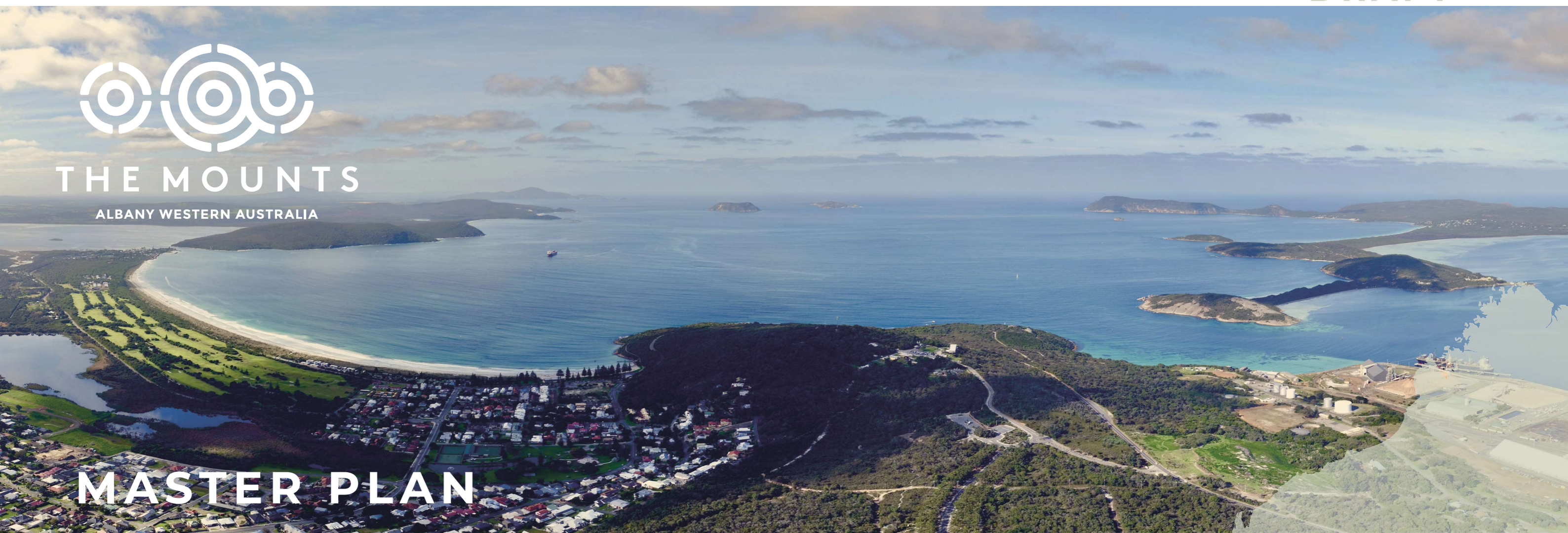

THE MOUNTS

ALBANY WESTERN AUSTRALIA



MASTER PLAN

MOUNT ADELAIDE *IRRERUP* MOUNT CLARENCE *CORNDARUP*

A PLAN TO CONSERVE + ENHANCE + CREATE AN ENDURING LEGACY

"Southwest Australia has emerged as one of the great areas in the temperate regions of the world. Half the species here are found nowhere else on earth and there's 8,000 species all up in the southwest floristic region, so it's incredibly rich. This is the oldest of the old; the granite rocks that form the low hills around Albany are a quarter of the age of the Earth itself – more than a billion years old... the age of the landscape appears to be part of the story."

Professor Stephen D Hopper
Winthrop Professor of Biodiversity, University of Western Australia



PERTH

ALBANY



THE CITY OF ALBANY
RESPECTFULLY ACKNOWLEDGES THE
MENANG NOONGAR PEOPLE AS THE
TRADITIONAL CUSTODIANS OF THE
LAND ON WHICH THE CITY CONDUCTS
ITS BUSINESS, AND PAYS RESPECT
TO ELDERS PAST AND PRESENT.

ISSUED
24.12.2020



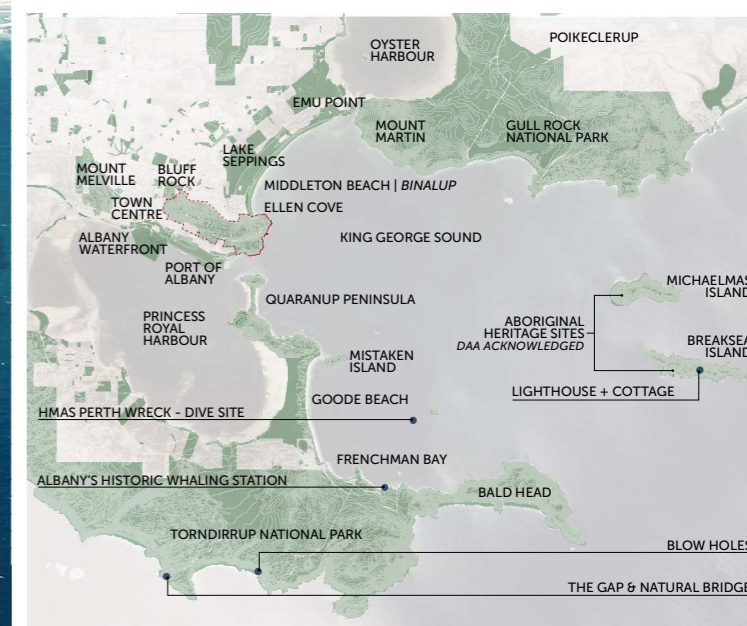

PROJECT OVERVIEW

MT ADELAIDE, MT CLARENCE AND SURROUNDING ENVIRONS IS A PLACE OF UNIQUE SOCIAL, CULTURAL AND NATURAL VALUE, CONTAINING ASSETS OF NATIONAL SIGNIFICANCE INCLUDING THE PRINCESS ROYAL FORTRESS, DESERT MOUNTED CORPS MEMORIAL AND NATIONAL ANZAC CENTRE.

The world-class natural environment of the Mounts is exceptional in many ways – in its ancient geology, sculptured granitic landforms with world-class views of the harbours and hinterland, and its abundant native vegetation rich in wildflowers and birdlife.

The site's Aboriginal cultural and natural values are considerable and should also be recognised in any future growth and development model.

Sought after increases in visitor attraction and experiences will require diversification, further investment and detailed planning. The potential economic, social and cultural benefits from ongoing and sustainable growth and development of the Mounts Precinct is well understood for Albany and the broader region.

PURPOSE OF THE MASTER PLAN

THE MOUNTS MASTER PLAN WILL PROVIDE A COMPREHENSIVE LONG TERM VISION FOR MT CLARENCE AND MT ADELAIDE WHICH RESPECTS AND ENHANCES ITS SIGNIFICANT NATURAL, CULTURAL, SOCIAL AND RECREATIONAL ASSETS AND ITS UNIQUE LANDSCAPE SETTING.

The master plan will establish a clear vision and refined set of guiding principles, which in turn drives an overarching but flexible framework and simple criteria to guide project outcomes, as well as identify strategies and inform decision-making to guide sustainable investment and management over time.

OBJECTIVES

THE MASTER PLAN ADDRESSES THE NEED TO ESTABLISH A STRATEGIC APPROACH TO ACHIEVE:

- a long term vision and strategic objectives for the site;
- an integrated master plan with long-term context;
- sustainable management and protection of significant natural and cultural assets;
- a strong market identity and brand;
- prioritised implementation;
- enhanced community ownership and place activation;
- increase visitation to tourism assets and commercial enterprises (such as National Anzac Centre);
- a strong governance framework;
- outcomes that will target a diverse range of user groups and generations.

PROJECT AREA + STRATEGIC CONTEXT

THE MASTER PLAN PROJECT AREA ENCOMPASSES APPROXIMATELY 242 HECTARES, BOUNDED BY THE CITY CENTRE, PRINCESS ROYAL HARBOUR AND MIDDLETON BEACH.

The project area is made up of a number of reserves on Crown land, with management responsibilities held primarily by City of Albany and a number of key stakeholders. Water storage, reticulation and power supply infrastructure and easements all occur within the reserves. A number of Aboriginal Heritage sites have been identified within the project area and are protected under the Aboriginal Heritage Act 1972.

TIMEFRAME

The master plan vision, objectives and action/implementation plans will be based on 25+ year timeframe:

- **Horizon 1 (short term): next 5 years (2026)**
- **Horizon 2 (medium term): next 14 years (2035)**
- **Horizon 3 (long term): 25+ years (2045)**

GEOLGY + TOPOGRAPHY

Southwest Australia has emerged as one of the great areas in the temperate regions of the world. Half the species here are found nowhere else on earth and there's 8,000 species all up in the southwest floristic region, so it's incredibly rich. This is the oldest of the old; the granite rocks that form the low hills around Albany are a quarter of the age of the Earth itself... more than a billion years old... the age of the landscape appears to be part of the story.

FLORA + FAUNA

BIODIVERSITY SIGNIFICANCE

MARINE ECOLOGY

FRIENDLY FRONTIER

The interactions between the European explorers (later settlers) and the Menang people were well documented and generally positive. The Menang were understandably wary of these intruders, and they were initially confused with returning spirits of the dead. Noongar tradition held that the dead were white, so these white faces were intimidating at the outset.

THE TOWN + SETTLEMENT

The first Commandant, Major Edmund Lockyer, was keen to call the settlement Frederickstown, after Frederick Augustus, Duke of York and Albany, but this name never became official. Until 1831, it was known as King George (or George's) Sound, but Governor James Stirling changed it to Albany.

DEFENCE + WAR

WW1 ANZAC ALBANY

"The protection of the Sound and Princess Royal Harbour is of vital importance for the general security of the Australian colonies in time of war. If left undefended the Sound becomes the weak point in the Australian system of defence."
Col. Peter Scratchley, 1881

PRINCESS ROYAL FORTRESS

The cliffs around Albany were looming ahead looking very desolate in their misty grey mantle... Looking through the glasses Albany appears to be a very pretty place... As we passed down the Harbour the sun lit up the hills on either side and our last view of Australia was a very pleasing if sad one."
Pte. William Kirkland

MONUMENTS + MEMORIALS

The first convoy, along with many other stories of the Great War, are commemorated in the National Anzac Centre on Mount Adelaide, which opened on the centenary of the convoy's departure in 2014.

THE NATURAL ENVIRONMENT | NOONGAR CULTURAL HERITAGE | EUROPEAN EXPLORATION | SHIPPING + MARITIME | TOURISM + RECREATION

SITE THROUGH TIME

CREATION STORIES

CONNECTION TO THE MOUNTAINS

MENANG PEOPLE

FIRE

The Noongar name for Albany itself is Kinjarling, or Place of Rain. The Noongar people have inhabited the area for thousands of years. They are one of the oldest surviving cultures of the world whose spirituality rests on ancestral beliefs of creation.

EUROPEAN EXPLORATION

THE DUTCH

THE FRENCH

THE BRITISH

CHARLES DARWIN

"King George's Sound had been chosen as the proper place in which to prepare ourselves for the examination of the south coast of Terra Australis, and I sought to make the best use of the advantages it might furnish."
Commander Matthew Flinders R.N., 9 December 1801

"They possess here some advantages, the climate is very pleasant, and more rain falls than in the Eastern colonies... The second grand advantage is the good disposition of the aboriginal blacks."
Charles Darwin, March 1836

SHIPPING + MARITIME

P&O ERA

LIGHTHOUSES

1908 THE GREAT WHITE FLEET

Once Albany became established as a major destination for shipping coming from both east and west, it became apparent that guidance, in the form of lighthouses, was needed. This was borne out by a series of shipwrecks on the dangerous south coast.

Whaling was the first industry in Western Australia. The first recorded whaling ship to visit the area was the *Elligood* in 1800, twenty-six years before European settlement.

TOURISM + RECREATION

WHALING INDUSTRY

Albany's moderate climate and unspoiled environment made picnicking a popular pastime in the 19th and early 20th centuries. Many locations lent themselves to outdoor meals and excursions and locals were quick to take advantage.

PARKS + PICNICS

MARINE DRIVE

"Circling Mount Clarence, and providing one route to Middleton Beach, is the Marine Drive, one of the finest scenic drives in Australia. Running along the hillside, high above the sea, the Drive permits views over the whole of the Sound and the inner Harbour. It leads on to Middleton Beach, with its sheltered cove at the West end and, farther round, excellent surf facilities where the rollers sweep in across the Sound."
Albany tourism promotion, 1933

WHEELER DRIVE

EYRE PARK

MIDDLETON BEACH

Middleton Beach became an increasingly popular place to visit towards the end of the 19th century, especially for those arriving by rail from the eastern regions following the discovery of gold at Coolgardie. Tourism increasingly became vital to Albany's progress, with the golf links and Marine Drive being constructed in order to attract visitors to Middleton Beach and the town generally. Over the decades, families have enjoyed camping, surfing, and learning to swim at this beautiful beach.

KEY DRIVERS

EIGHT KEY DRIVERS HAVE BEEN IDENTIFIED WHICH DEFINE A DIVERSITY OF SUSTAINABLE ASSETS AND OPPORTUNITIES.

Each key driver is expected to impact different areas of social and economic development within the City of Albany and the wider South Coast region, with the primary intention to bolster Mt Adelaide and Mt Clarence's position as the center and focus of activity for other areas of influence.



MENANG CULTURAL HERITAGE

Tell stories, interpret and share significant Aboriginal heritage of the landscape. Develop and grow enterprise development work and education programs that will acknowledge and celebrate the role of traditional owners, through legacy projects which engender respect and shared custodianship.



ANZAC LEGACY

Commemorate, interpret and share our unique connection to the Anzac story, providing a world-recognised cultural pilgrimage for Australians and visitors to remember those who served.



SUSTAINABLE COMMUNITIES

Develop and promote activities and services focused on both visitors and locals that will nurture civic pride, strong partnerships, and growth of a collaborative network throughout the region, Perth and beyond.



POST-COLONIAL HERITAGE

Enhance and interpret the significant post-colonial heritage of the site. Embrace the potential for discovery and interpretation of world recognised natural environment with rich layers of settlement, maritime and military history.

PROJECT PROCESS



RESEARCH, EDUCATION + COLLECTIONS

Engage the next generation and facilitate a better understanding of the site and the region through leading research and education programs. Increase the potential for discovery and interpretation of natural environment and rich layers of history through protecting and enhancing natural assets; facilities and built fabric; collections and displays; stories and memories.



CARE + CONSERVE

Protect and promote the site's natural beauty and embrace the region's status as a world recognised biodiversity hotspot. Adopt sustainable and adaptive management practices that will implement appropriate uses and enhance significant natural environments and places.



ENTERPRISE + ECONOMY

Develop and support enterprise that is financially sustainable and resilient to change, supports local business and creates jobs, and positions the park and the facilities within it as a world class visitor destination, ultimately extending visitor stays in Albany and contributing to growth in the region's economy.



DIVERSITY OF EXPERIENCE

Provide a diverse range of activities and experiences that will delight, educate, engage and sustain visitation. Create a vibrant and inclusive place that encourages passive and active recreation, art and creativity and engages people through authentic and memorable experiences.



BACKGROUND CONTEXT

CHARACTER PRECINCTS + NEIGHBOURHOODS

DRAFT

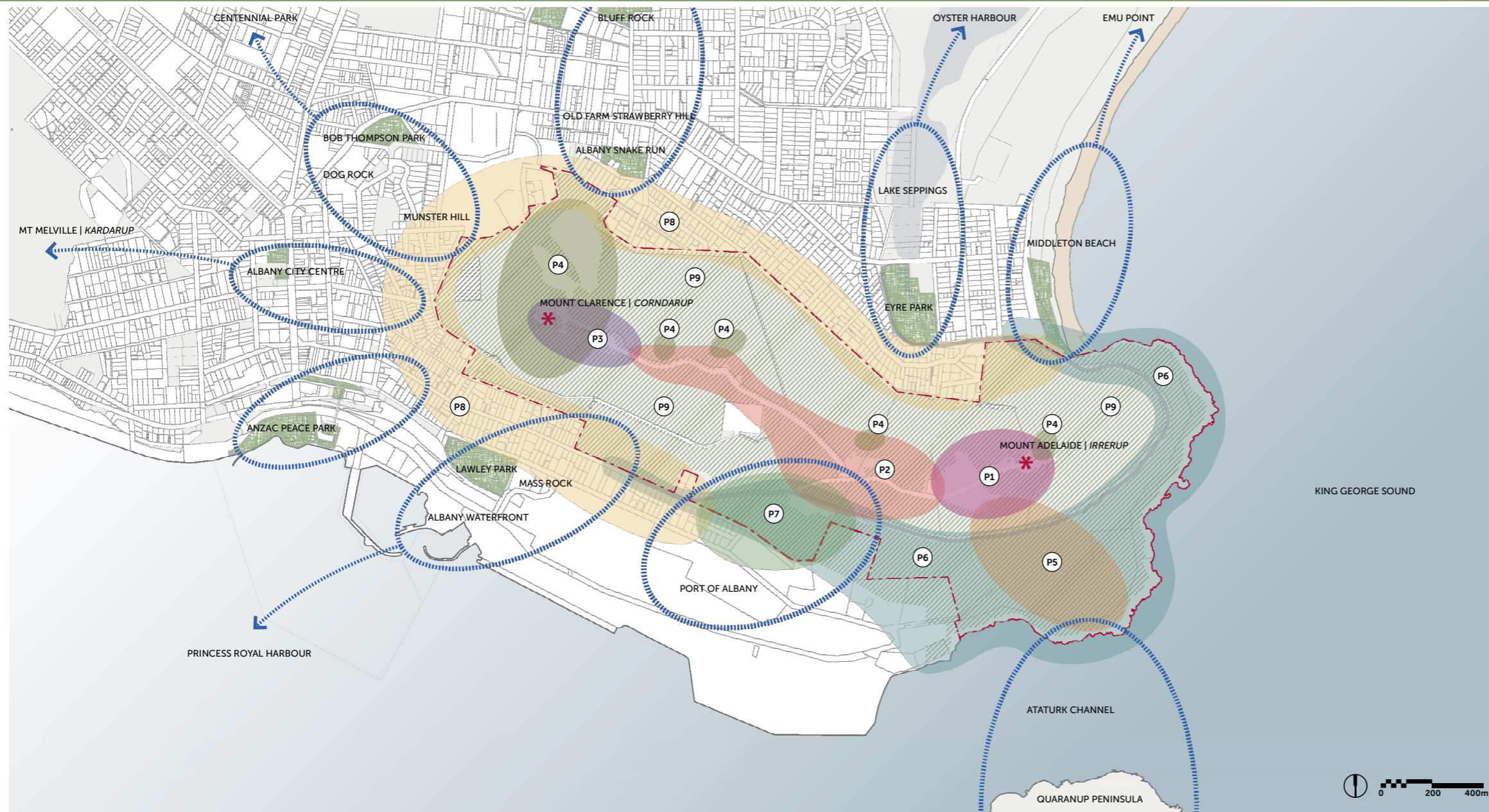

LEGEND

- P1 PRINCESS ROYAL FORTRESS
- P2 RIDGE
- P3 DESERT MOUNTED CORP
- P4 GRANITE OUTCROP
- P5 RANGE
- P6 COASTAL EDGE + MARINE DRIVE
- P7 PORT INTERFACE
- P8 URBAN EDGE
- P9 BUSHLAND
- Parks
- Gateway Neighbourhoods
- * Mount Summit
- Site Boundary

GATEWAY NEIGHBOURHOODS

For the purpose of analysing the economic and social importance of Mt Clarence and Mt Adelaide and the site's context as a central hub of activity within Albany, the surrounding areas have been dissected into a number of Gateway Neighbourhoods. Each contain various supporting assets, with their own distinct social, environmental and/or economic contributions.

CHARACTER PRECINCTS

NINE PRECINCTS HAVE BEEN IDENTIFIED, EACH WITH ITS CHARACTER, IDENTITY AND UNIQUE INTERFACE WITH THE SURROUNDING ENVIRONMENT AND NEIGHBOURHOODS.
PRINCESS ROYAL FORTRESS

Positioned atop Mt Adelaide | *Irrerup* the precinct looks south out past the islands through the entrance to King George Sound, and east across Oyster Harbour to the rural hinterland of Albany.

Est. 1893 as the first coastal defences for the colony and trade routes, the precinct is rich in military history. Today the site layers a wealth of historical, contemporary, cultural, commemorative and natural assets.

Surrounding granite outcrops are important Aboriginal ceremonial grounds, and the jarrah, marri and yate bushland hold significant aesthetic value. The precinct is the honeypot, the orientation, the microcosm of all that the Mounts offer to visitors and locals alike.

MT ADELAIDE | IRRERUP, MT CLARENCE | CORNDARUP MASTER PLAN

THE RIDGE

Entry to the Park is through this precinct and thus an important orientation point for visitors. Apex Drive with its Avenue of Honour Trees, links the two summits of Mt Clarence and Mt Adelaide. The Apex Drive Avenue honours those killed in the two World Wars and the Korean War. Bushland adjacent to Apex Drive, a Noongar Aboriginal burial site persists unnoticed save for the spectacular summer flowers of the *Mooodjar* or Christmas trees that adorn the deep sand adjacent. The precinct is a reflective space for two cultures commemorating lost loved ones together.

DESERT MOUNTED CORPS

The Desert Mounted Corps Memorial and Padre White Lookout stands at the summit of Mt Clarence | *Corndarup*, from offers world-class views of the surrounding landscapes and a visual link across the Town Centre to Mt Melville | *Kardarup*. The precinct is the site of Albany's Anzac Day dawn service each year and provides infrastructure to host significant crowds and visitation.

COASTAL EDGE + MARINE DRIVE

A rich maritime history prevails, from traditional Aboriginal times, early explorers and a long standing shipping industry. The coastal boardwalk and trail is a sensory rich experience following the rugged granite coastal edge and undulating dunes, offering close encounters with native fauna and marine life. Marine Drive, hugging the slope of Mt Adelaide, is considered one of Australia's most spectacular short scenic routes. Multiple lookouts and vantage points provide views over the coast line, islands and working port infrastructure.

THE RANGE

The Range precinct provides a direct link between the upper and lower fortress and gun emplacements.

The south-east slope of Mt Adelaide proved suitable for troop's small-arms practice during war time, and the low coastal vegetation was cleared to enable this military use. Today the disturbed bushland is dotted with historical features, memories and untold stories.

PORT INTERFACE

Historically an industrial site, this cleared and now degraded landscape has potential to be formalised as the entry gateway for the Mounts.

Views over the working operations of the port highlight the inland rural economies that the Port of Albany serves.

URBAN EDGE

Interface with the sites surrounding neighbourhoods. The character of this precinct transitions from residential neighbourhoods to the urban character of the Town Centre and through to industrial port activities.

Mt Adelaide and Mt Clarence forms the backdrop for educational sites like Albany Senior High School and the recreational backyard for numerous residents. A number of formal and informal entry points punctuate the site bringing numerous environmental issues as well as a lack of orientation and wayfinding.

GRANITE OUTCROP

The granite outcrop vegetation is rich in rare micro-communities of plants. Sheet rock on seeps has a biofilm of dark cyanobacteria that is notoriously slippery when wet. Drier rock is usually covered with crustose lichens. Moss forms green and grey mats where the shallowest of soils can take hold. They are sensitive ecosystems, easily damaged and the home to vulnerable threatened plant species found on the Mounts.

BUSHLAND

Home to more native plants than Perth's Kings Park, the bushland is the largest precinct on the Mounts. There are distinctive and localized Albany coastal headland vegetation types on the Mounts, dominated by low woodlands, forest and thickets, and the diverse granite outcrop vegetation layers, all responding to differential soil depth and moisture.



STRONG GOVERNANCE + LOCAL COMMUNITY

Foster local ownership and pride and enhanced community participation - embedding programs, services and activity to enhance social cohesion, sustainability and prosperity, and promote intergenerational experiences - targeting everyone from family networks and kids, to seniors.

KEY PROJECTS + INITIATIVES

ESTABLISHMENT OF A GOVERNANCE FRAMEWORK

- The Mounts Master Plan's vision is driven by eight Key Drivers and underpinned by nine Strategies which contain projects and initiatives for staged implementation. Management responsibilities are held primarily by the City of Albany and a number of key stakeholders.

'FRIENDS OF THE MOUNTS'

- Recognise the high community values of the site
- Conservation and bushland management
- Horticulture and education
- Volunteer support networks and special projects
- Establish a volunteer guides programme

STAKEHOLDER + COMMUNITY ENGAGEMENT STRATEGY

- Foster a stronger sense of community ownership and public empowerment through an ongoing engagement process and the development and implementation of a refreshed and expanded communication strategy.
- Collaboration and partnership focus with community groups, commercial enterprises and government agencies, such as: Kings Park and Botanical Gardens, UWA, WA Museum, National Archives, Australian War Memorial Arts organisations
- Broaden global references and context for international visitors

NATIONAL HERITAGE LISTING

- Nominate the place for listing as a national heritage site and a place of outstanding heritage significance to Australia



NOONGAR MENANG CULTURE: ABOUT COUNTRY BOODJA

Recognising Menang Noongar culture as central to the regions' identity. The Mounts and its surrounds hold substantial cultural significance to the local Aboriginal Menang peoples, whom have extensive knowledge and stories to share about the area, for locals and visitors alike.

KEY PROJECTS + INITIATIVES

CONNECTION TO COUNTRY BOODJA

- Recognising Menang Noongar culture as central to the regions' identity

DUAL NAMING

- Progress and implement dual naming across the Mounts and surrounding landscapes (places, elements, locations)

SUPPORT ABORIGINAL TOURISM

- Promote and support Aboriginal tourism operators
- Development of outdoor gathering spaces for tour group gathering and storytelling

ART + STORYTELLING

- Explore and develop opportunities for how public art, storytelling and interpretation can act as a mechanism for cultural exchange, creative expression and place enhancement and creates new layers of narrative and substance to the locality, while cherishing and showcasing the existing qualities and character of the place.
- Dale Panorama artwork by Lieutenant Robert Dale is an evocative portrayal of European-Menang relationships which gave rise to the description of Albany as the 'Friendly Frontier'. The artwork has inspired a cultural overlay to the Mounts: an imperative to tell the story of Albany from different perspectives.



PLACE VITALITY + EVENTS PROGRAM

Create new public art experiences and lasting cultural tourism products, assets and infrastructure to support engaging visitor experiences, deliver a significant cultural legacy, and help create a vibrant place for current and future generations - towards a new identity as the cultural capital of regional Western Australia.

KEY PROJECTS + INITIATIVES

ALBANY: KINJARLING CONNECT IN 2026

- Explore opportunities for the Mounts to mark the bicentennial of the founding of Western Australia's first British Colony in Albany 2026 - a cultural milestone of national significance

CULTURAL NETWORK STRATEGY

- Link site-wide projects, events, programmes and initiatives to City-wide arts and culture strategy, incorporating key cultural assets

EVENTS + ARTS PROGRAM

- Develop a year round seasonal events, exhibition and place programming strategy specific to the site i.e. 'Festival of the Mounts'



RESEARCH + EDUCATION PROGRAMS

Engage the next generation and facilitate a better understanding of the site and region through leading research, education and discovery and storytelling.

KEY PROJECTS + INITIATIVES

SCHOOL EDUCATION PROGRAM

- Promote development of school based education and excursion programs linked to existing curricula and national strategies for international education. Target science, history and heritage (such as; Anzac, seasons, biodiversity, whales etc.)

TERTIARY KNOWLEDGE + INNOVATION PROGRAM

- Develop MOU's with institutions such as University of Western Australia, Curtin University and TAFE to deliver environmental, recreational, horticultural and tourism-based research, such as data collection and monitoring.

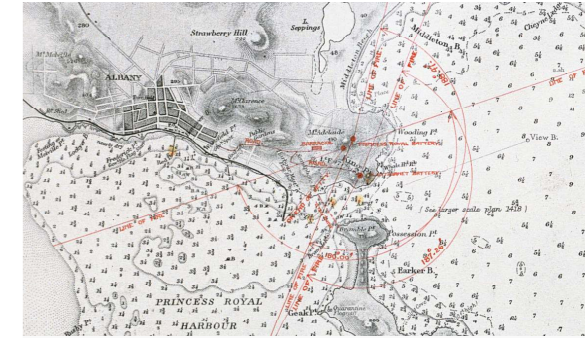

PRINCESS ROYAL FORTRESS : RE-CONNECT UPPER + LOWER FORTS

The Princess Royal Fortress (opened in 1893) encompassing the Princess Royal Battery, Plantagenet Battery and surrounding landscape, is a valued local asset of national historical significance, with significant potential to expand and improve the experience of the National Anzac Centre and Mounts community precinct.

KEY PROJECTS + INITIATIVES

THE GUNS OF THE FORTRESS

- Restore and interpret both original batteries and landscape settings including gun emplacements with guns, magazines, shell stores and bunkers.

CONNECT THE UPPER + LOWER FORTS

- Physically re-connect upper Princess Royal Fortress and lower Plantagenet Battery sites through trails and interpretive reveals of hidden sites and history

HERITAGE + CULTURAL SIGNIFICANCE PLAN

- Identify cultural and commemorative assets within the precinct and reference to the history of Albany and neighbouring heritage assets, such as; DMC, Camp Quaranup (graves, memorial), Albany Waterfront, Peace Park, WA Museum, Cemetery, Strawberry Hill Farm, St Johns Church, Ellen Cove.

UNDERTAKE A COLLECTION + EXHIBITION AUDIT

- Refining the focus of collections based on direct provenance to place, and develop cross promotion strategy with the NAC and other agencies, such as; Museum WA.

BUILDINGS + INFRASTRUCTURE ADAPTIVE REUSE PLAN

- Employ best practice contemporary design to maximise the impact of heritage building assets. Strategically plan for the future expansion of improved visitor amenities, and removal of non-significant buildings (such as HMAS Perth centre and outbuildings).

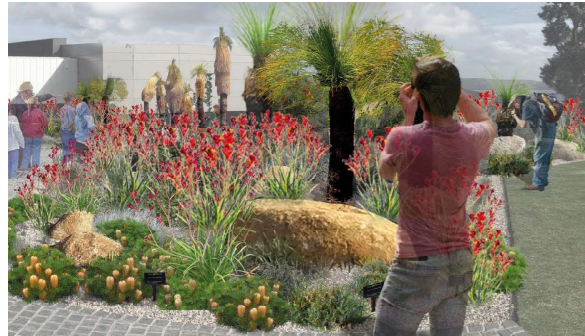

SUSTAINABLE BIODIVERSITY + BUSHLAND BOTANIC GARDENS

The establishment of a world-recognised regional botanic garden network showcasing the regions unique landscape, biodiversity and natural environment – providing inspirational experiences to enhance life – and key to the adoption of sustainable and adaptive management practices that will implement appropriate uses and enhance significant natural environments and places.

KEY PROJECTS + INITIATIVES

LANDSCAPE MANAGEMENT + SUSTAINABILITY

- Conserve and enhance natural bushland and rare granite outcrop environments. Align natural reserve management practices to City's Natural & Developed Reserves Management Strategy(s) and Environmental Code of Conduct.
- Good future management promoting sustainable practices and value systems for caring for country, completing the biological inventory, researching the major threatening processes and monitoring and taking appropriate action to conserve those species and communities most at risk.
- Understand, map and communicate the landscape values of the site, and protection and enhancement programs and strategies.

BOTANIC DISPLAY GARDENS + COLLECTIONS

- Develop, plan and implement a regional botanic garden aligned with best practice and UWA and Great Southern Biodiversity / Botanic garden Network Strategy (GSDC).
- Staged implementation of curated, developed display gardens aligned with best practice; celebrating local and regional landscape biodiversity.
- Provide a node of consolidated infrastructure to support the working operations and management of the bushland and Botanic Gardens, including a visitor hub, glass houses, plant nursery and storage facilities.

RESEARCH + EDUCATION

- Stimulate new opportunities for the research and education sector through enhanced partnerships and access to improved natural, cultural or heritage sites and associated information.



NATIONAL ANZAC CENTRE, VISITOR SERVICES + ESSENTIAL INFRASTRUCTURE

Identify, refurbish and enhance key infrastructure and public realm assets to ensure the continued successful operation and continually improving visitor experience within the broader Mounts precinct (Mt Adelaide, Mt Clarence and environs), and revitalised Princess Royal Fortress (PRF) and National Anzac Centre precinct. Continue to provide a dynamic approach to museum collection and display material, in order to encourage repeat visitation and maintain contemporary relevance of the museum.

KEY PROJECTS + INITIATIVES

NAC CONTENT + COLLECTIONS STRATEGY

- Review, refresh and improve to ensure interpretative experiences remain relevant, engaging and consistently high quality
- Develop and implement a strategy in partnership with WA Museum to manage NAC cultural and commemorative assets, including objects (loans, conservation requirements) and interpretative content (graphic and multimedia), and review and update curated multimedia content, permanent and rotating exhibitions.

VISITOR ACCESS + TOURISM SERVICES HUB

- Provide a central, well-connected and active arrival, parking and orientation system within Princess Royal Fortress to support visitor operation and tourism product services.
- Formalise and improve the visitor arrival sequence, orientation spaces and facilities for guided and self-guided experiences and commercial tourism operators.

INFRASTRUCTURE UPGRADES + ESSENTIAL SERVICES

- Build upon recently completed works to support site activation e.g. footpaths, lighting, bins, seating, shelters

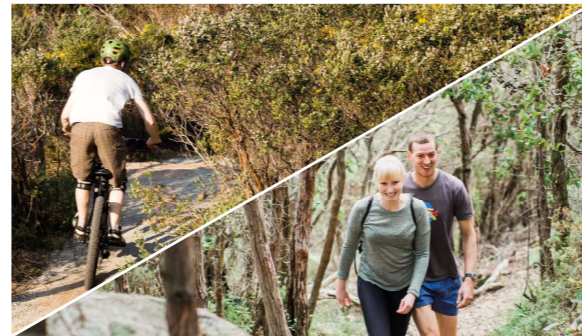

ICONIC TRAIL NETWORK

Development of a site responsive trail network system that is balanced, legible, safe and well connected, linking major destinations, neighbourhoods and activity nodes within the city, and catering to a range of different trail users, styles, levels of difficulty and experience (active, passive, heritage, nature) - whilst ensuring the protection of the sites' environmental, cultural and heritage values.

KEY PROJECTS + INITIATIVES

MOUNTAIN BIKE TRAIL NETWORK

- A single-use link MTB link trail network through Mt Clarence (Corndarup) + Mt Adelaide (Irrerup) connecting surrounding precincts of Middleton Beach, City Centre and Waterfront and linking geographical features to provide fun and challenging experiences catering for beginner to intermediate riders.

WALKING TRAIL NETWORK

- Single use link and circular walk trails connecting Mt Clarence (Corndarup) + Mt Adelaide (Irrerup) and connecting surrounding precincts of Middleton Beach, City Centre and Waterfront. Unique natural and recreational experience with iconic views and a bushland experience.

THE MOUNTS COASTAL TRAIL

- Enhance the iconic coastal shared-use trail from Middleton Beach to the Port and Town Centre, showcasing information and linking sites of natural, cultural and historical significance

DRIVING + PUBLIC TRANSPORT EXPERIENCE

- Enhance the driving experiences with clear and legible, well sign posted road network, designated turn-around, drop-off and parking areas at key destinations.
- Upgrade park gateways and orientation nodes, ocean experience lookouts, access ways, pedestrian links

CONNECTING TO NEIGHBOURHOODS

- Develop physical connections with adjacent neighborhoods. Infrastructure upgrades and safe accessible connector paths completing shared path links between the Waterfront and the Mount summits.



PLACES TO LEARN + PLAY

The Mounts can provide unique experiences for nature based play and learning to enhance its community and visitor appeal – encouraging kids interacting outdoors and in nature to inspire positive environmental awareness, cognitive, emotional and physical development, through discovery and connection with nature.

KEY PROJECTS + INITIATIVES

NATURE PLAY

- Located at PRF in the area of maritime gun artefacts, a place to play and promote the development of nature-based activities, gathering and experience structured around interpretive themes significant to the Mounts.

NATURE BASED ACTIVITIES

- Programme of inspired outdoor experiences through events, catering for children and family-based activities

DESIGNATED EDUCATION SPACES

- Development of outdoor designated education spaces for tour group gathering and storytelling and indoor, adaptive reuse of the Forts buildings to optimise use and participation.



STORIES, INTERPRETATION + WAYFINDING

Increasing the potential for the discovery and interpretation of natural environment and rich layers of history, through protecting and enhancing natural assets; facilities and built fabric; collections and displays; stories and memories. Development of a consistent, clear and legible brand and wayfinding system so that visitors are able to easily identify, navigate and interpret locations in a diverse network of activities and destinations.

KEY PROJECTS + INITIATIVES

SITE-WIDE INTERPRETATION STRATEGY

- Connecting stories, interpreting information, connecting view lines to adjacent precincts and neighborhoods
- Key interpretation themes based around: Our Environment, Noongar Menang Culture, Colonial Heritage, Military Heritage

VISITOR ORIENTATION + WAYFINDING STRATEGY

- Redefine the existing hierarchy of park 'gateway' entry and points of arrival, activity nodes and network of destinations to help user navigation and promote and improve the visitor experience

CONNECTING DESTINATIONS + ATTRACTIONS

- Explore ways to integrate adjacent neighborhood reserves and connect to places, such as; Visitor Centre

REDEFINE THE BRAND

- Understand the perception of the Albany Heritage Precinct and develop a strong cohesive brand (such as 'The Mounts') that incorporates a collection of existing brand elements
- Develop communications, marketing and promotions plan aligned with Albany Visitor Centre and Amazing South Coast brand

MOUNTS MASTER PLAN

KEY PROJECTS + INITIATIVES - SITE PLAN

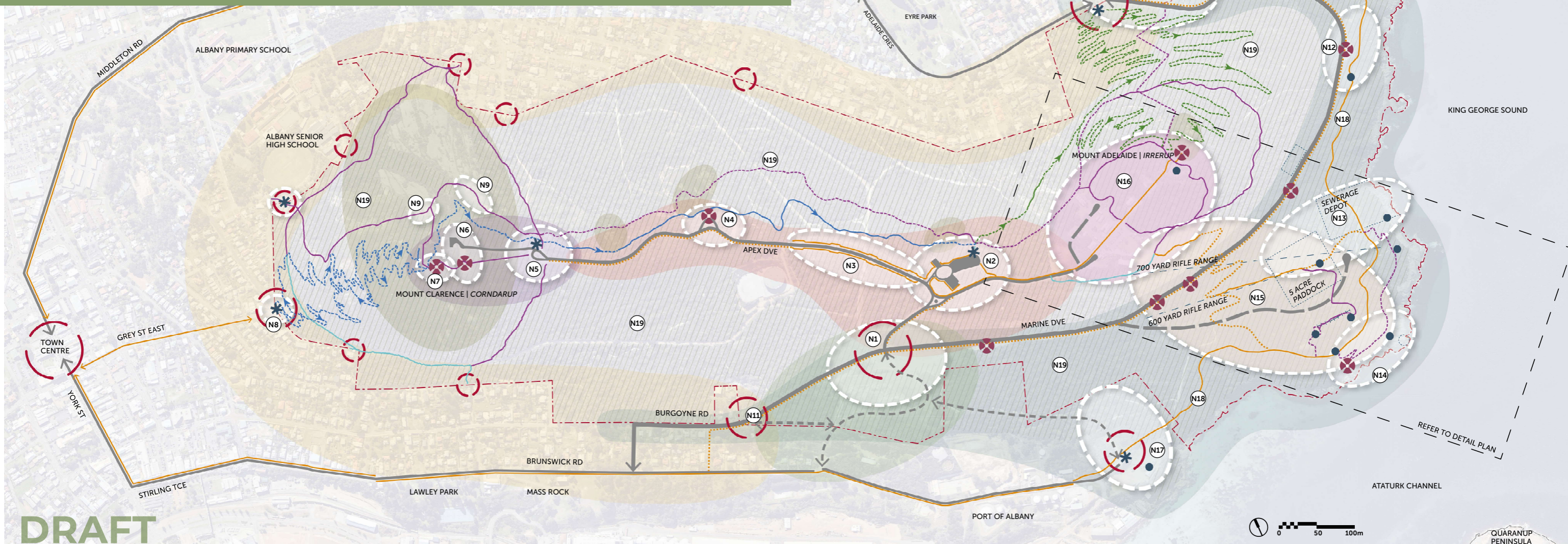

DRAFT

CHARACTER PRECINCTS

- PRINCESS ROYAL FORTRESS
- THE RIDGE
- DESERT MOUNTED CORP
- GRANITE OUTCROP
- THE RANGE
- COASTAL EDGE + MARINE DRIVE
- PORT INTERFACE
- URBAN EDGE
- BUSHLAND

GENERAL LEGEND

- Existing Shared Track - Unsealed
- Proposed Shared Track - Unsealed
- Existing Shared Path - Sealed
- Proposed Shared Path - Sealed
- Existing Walk Track
- Proposed Walk Track
- Existing Mountain Bike Trail - easy
- Proposed Mountain Bike Trail - easy

- Existing Mountain Bike Trail - intermediate
- Proposed Mountain Bike Trail - intermediate
- Primary Trail Head
- Existing Road Linkage
- Proposed Road Linkage
- Site Boundary

* All remaining fire breaks remain as shared use connectors

* May include some or all of the following:

- PROPOSED ACTIVITY NODE -**
Increased amenity, planting, safety + security, events, integrated public art, interpretation, education + wayfinding, technology.
- GATEWAY -**
Define character of key entry | gateway nodes. Signage, dual naming, lighting, integrated art, interpretation and wayfinding
- LOOKOUT -**
Improved parking + amenities, themed interpretation, maintain views with vegetation management
- HERITAGE SITE | ENVIRONMENTAL FEATURE -**
To be protected and enhanced

KEY PROJECTS + INITIATIVES

- N1 PARK ENTRY | GATEWAY NODE**
Visitor info and views to Port landscape. Roundabout at intersection and possible road linkage to Port. Connection to coastal walk trail.
- N2 CARPARK + TRAILS HUB NODE**
Improved wayfinding at roundabout. Enhance trail hub. Improve wayfinding and promote links to the mounts and surrounding precincts. Public toilet facilities and commercial opportunity. Consolidate existing trails and develop a series of walk trail loops suitable for different walking abilities. Environmental and Menang interpretation along walks. Named walks to create a strong identity.
- N3 AVENUE OF HONOUR NODE**
Recognised as a contemplative and respectful space. Appropriate events and programming. Slow traffic, improve facilities, encourage visitors to dwell. Improve maintenance of trees and plaques. Integrated public art opportunities.
- N4 APEX DRIVE LOOKOUT NODE**
Remove existing trail head. Wayfinding and interpretation. Integrated art and storytelling opportunities ie. the 1843 Dale Panorama.
- N5 CARPARK NODE**
Resolve parking conflicts, slow traffic and improve vehicle circulation. Upgrade public toilet facility. Improve lighting and night safety.

- N6 DESERT MOUNTED CORPS MEMORIAL NODE**
Resolve parking conflicts, slow traffic and improve vehicle circulation. Improve wayfinding and interpretation. Connect and consolidate existing trails, create network of walk trail loops suitable for different walking abilities.
- N7 PADRE WHITE LOOKOUT NODE**
Integrated art and storytelling opportunities ie. the 1843 Dale Panorama. Improve wayfinding and interpretation. Connect and consolidate existing trails, create a network of walk trail loops suitable for different walking abilities.
- N8 TRAIL HEAD | ENTRY NODE**
Gateway entry point with wayfinding and signage.
- N9 GRANITE CROSSING NODES**
Consolidate and upgrade existing trails. Boardwalk sections of the trail over sensitive granite outcrops to prevent erosion and ensure protection. Interpretation of natural environment including granite outcrop ecosystem, geology and Menang cultural heritage. Establish links to broader landscape through storytelling and orientation - Dog Rock, Bluff Rock,

- N10 ELLEN COVE NODE**
Park entry point | Trail head. Wayfinding and interpretation. Integrated art opportunities. Place naming including dual naming.
- N11 MARINE DRIVE**
Entry statement at either end of Marine Drive. Resurface road with red asphalt to announce arrival into a tourist precinct. Slow traffic speeds. Reinstate representation of historic gates - precise location TBC. Shared path along length of Marine Drive linking Lawley Park and Town Centre to Middleton Beach.
- N12 ROTARY LOOKOUT NODE**
Upgrade existing carpark and lookout facilities. Wayfinding and interpretation.
- N13 COASTAL PARKLAND NODE**
Opportunity for Coastal Parkland and Botanic garden in degraded historic sewerage depot site and 5 acre paddock. Vehicle access from Marine Drive and carpark. Picnic, shelter and BBQ facilities.
- N14 POINT KING LIGHTHOUSE + COASTAL NODE**
Upgrade lookout and provide coastal link from lookout and Ataturk Memorial to Point King Lighthouse.

- N15 RIFLE RANGE NODE**
Refer to Proposed Initiatives Detail Plan
- N16 PRINCESS ROYAL FORTRESS | MT ADELAIDE NODE**
Refer to Proposed Initiatives Detail Plan
- N17 PORT COTTAGES NODE**
Opportunity for a commercial / business venture. Carpark and gateway entry point for coastal walktrail. Road linkage
- N18 COASTAL WALK TRAIL**
Upgrade of the coastal walk trail, linking sites of natural, cultural and historical significance with interpretation, seating nodes and public art.
- N19 BUSHLAND AREAS**
Protection of areas of excellent vegetation condition and granite outcrop management. Conserve bushland buffer around site perimeter. Repurpose existing degraded areas as activity nodes. Consolidate and upgrade existing trails to prevent erosion and ensure protection of bushland and granite outcrops. Environmental and Menang interpretation opportunities.

* Proposed initiatives to minimise impacts on flora and fauna, in particular threatened and priority species, will be in accordance with the City of Albany Environmental Code of Conduct.

MOUNTS MASTER PLAN

KEY PROJECTS + INITIATIVES - DETAIL SITE PLAN

DRAFT

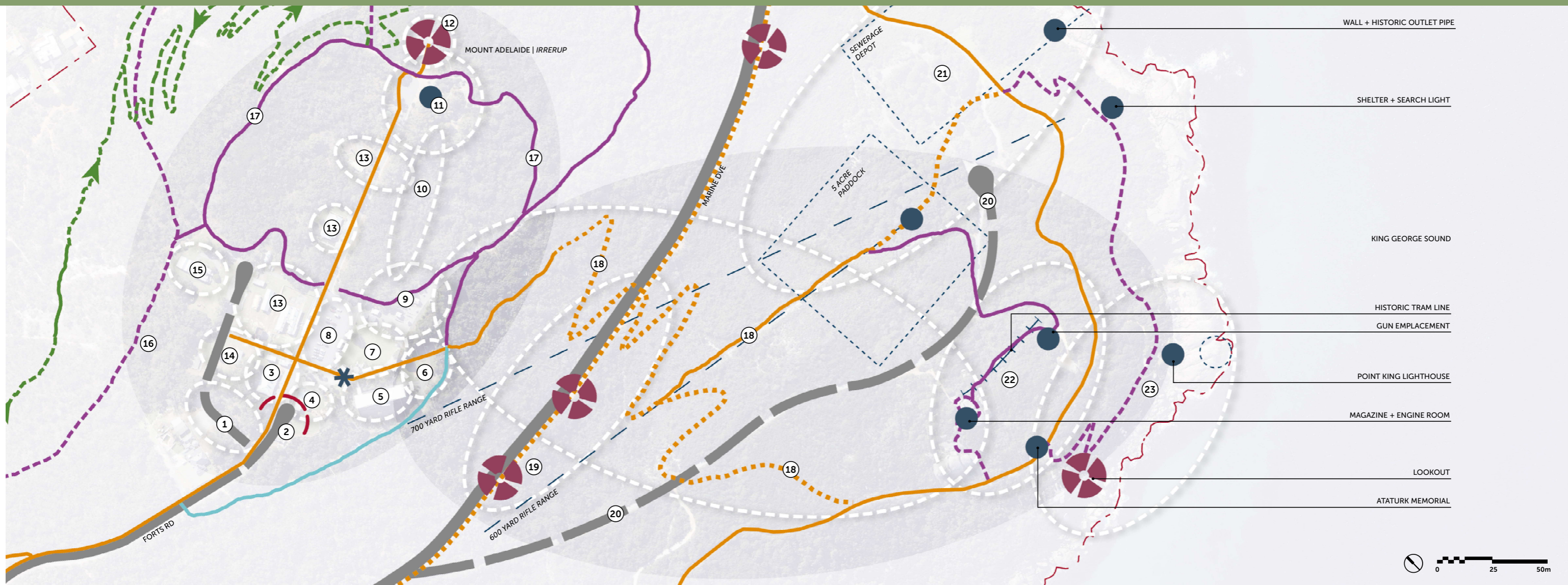

GENERAL LEGEND

- Existing Shared Track - Unsealed
- - - Proposed Shared Track - Unsealed
- Existing Shared Path - Sealed
- - - Proposed Shared Path - Sealed
- Existing Walk Track
- - - Proposed Walk Track
- Existing Mountain Bike Trail - easy
- - - → Proposed Mountain Bike Trail - easy
- Existing Mountain Bike Trail - intermediate
- - - → Proposed Mountain Bike Trail - intermediate
- * Primary Trail Head
- Existing Road Linkage
- - - Proposed Road Linkage
- - - Site Boundary

* May include some or all of the following:

- PROPOSED ACTIVITY NODE -**
Increased amenity, planting, safety + security, events, integrated public art, interpretation, education + wayfinding, technology.
- GATEWAY -**
Define character of key entry | gateway nodes. Signage, dual naming, lighting, integrated art, interpretation and wayfinding
- ⊗ **LOOKOUT -**
Improved parking + amenities, themed interpretation, maintain views with vegetation management
- HERITAGE SITE | ENVIRONMENTAL FEATURE -**
To be protected and enhanced

* Proposed initiatives to minimise impacts on flora and fauna, in particular threatened and priority species, will be in accordance with the City of Albany Environmental Code of Conduct.

KEY PROJECTS + INITIATIVES

- 1 PARKING NODE**
Increase parking capacity.
Improve vehicle access & circulation, lighting & wayfinding.
Improve landscape amenity.
- 2 TURN AROUND**
Introduce traffic circulation & flow control measures which connects to parking upgrades & preserves setting of historic parade ground.
Entry Statement - planting & signage
- 3 FORTS STORE**
Protect, interpret & repurpose historic buildings/ building sites for display & commercial opportunities.
- 4 COMMERCIAL NODE**
Create a primary welcome & orientation point with central wayfinding feature.
Improve landscape amenity & potential Botanic Garden
- 5 NATIONAL ANZAC CENTRE**
- 6 SUBMARINERS MEMORIAL AMPHITHEATER NODE**
Improve pedestrian access & amenity for all users.
Enhance existing & develop new lookout & interpretation nodes.

- 7 GATHERING / EVENT NODE**
Formalise central point for group orientation, education, tours, school groups.
Introduce more outdoor shade.
Display seasonal exhibitions & collections.
- 8 PARADE GROUND NODE**
Improve historical interpretation
Enhance historical setting by removing permanent parking & consider returning to original size
- 9 RECREATION NODE**
Opportunity to create a new play space catering for family activities, based on interpretive themes.
Seating, lighting, pedestrian & wayfinding amenity.
- 10 LEWIS GUN PITS NODE**
Enhance interpretation & viewing experience of dual gun emplacements.
Improve pedestrian & wayfinding amenity.
- 11 GUN EMPLACEMENT NODE**
Enhance interpretation & viewing experience of dual gun emplacements.
Improve view lines at gun lookouts to ocean, harbour & lower forts precinct.
Improve pedestrian amenities & interpretive trails.
- 12 CONVOY LOOKOUT NODE**
Opportunities for Menang cultural interpretation

removed from direct military context. Interpret story of Irrerup ie. the 1843 Dale Panorama.
Develop trails which may be self-guided and/or guided.

- 13 GALLERY | EXHIBITION NODES**
Protect, interpret & repurpose historic buildings/ sites for display, commercial opportunities, community use.
- 14 MENANG CULTURAL NODE**
Establish an orientation & storytelling point for cultural tours & interpretation, with improved facilities & landscape amenity; reestablishing Connection to Country
- 15 COMMERCIAL NODE**
Protect, interpret & repurpose historic buildings/ sites for display, commercial opportunities, community use.
- 16 CAMPING NODE**
Recreational & educational camping facilities.
Develop interpretation of historic campgrounds.
- 17 ICONIC MT ADELAIDE | IRRERUP TRAIL**
Loop walk trail linking heritage and bushland assets.
- 18 RIFLE RANGE + BOTANIC GARDEN LINK NODE**
Improve connection to Lower Forts precinct through botanic garden & interpretive trails.
Utilise previously cleared 5 acre paddock. Selected vegetation clearing, opening up significant view scapes.
Footbridge crossing over Marine Drive.

Play spaces and commercial opportunities.
Upgrade, maintain and interpret heritage features.

- 19 MARINE DRIVE LOOKOUTS**
Upgrade facilities, interpretation and wayfinding to enhance and promote the drive experience.
- 20 LOWER ACCESS ROAD + CARPARK**
Open existing 1893 fire access track to provide vehicle access to Lower Forts and Coastal Parkland.
Vehicle turn around and carpark.
- 21 COASTAL PARKLAND NODE**
Opportunity for Coastal Parkland and Botanic garden in degraded historic sewerage depot site.
Vehicle access from Marine Drive and carpark.
Picnic, shelter and BBQ facilities.
Upgrade of the coastal walk trail, linking sites of natural, cultural and historical significance with interpretation, seating nodes and public art.
- 22 LOWER FORTS NODE**
Upgrade, maintain and interpret heritage features.
Provide connection between Princess Royal Fortress and Lower Forts.
- 23 POINT KING LIGHTHOUSE + COASTAL NODE**
Upgrade lookout and provide coastal link from lookout and Ataturk Memorial to Point King Lighthouse.

APPENDIX 1 : KEY PROJECT SHEETS

APPENDIX 2 : ANALYSIS OF COMMUNITY + STAKEHOLDER ENGAGEMENT REPORT, ISSUED FEBRUARY 2020

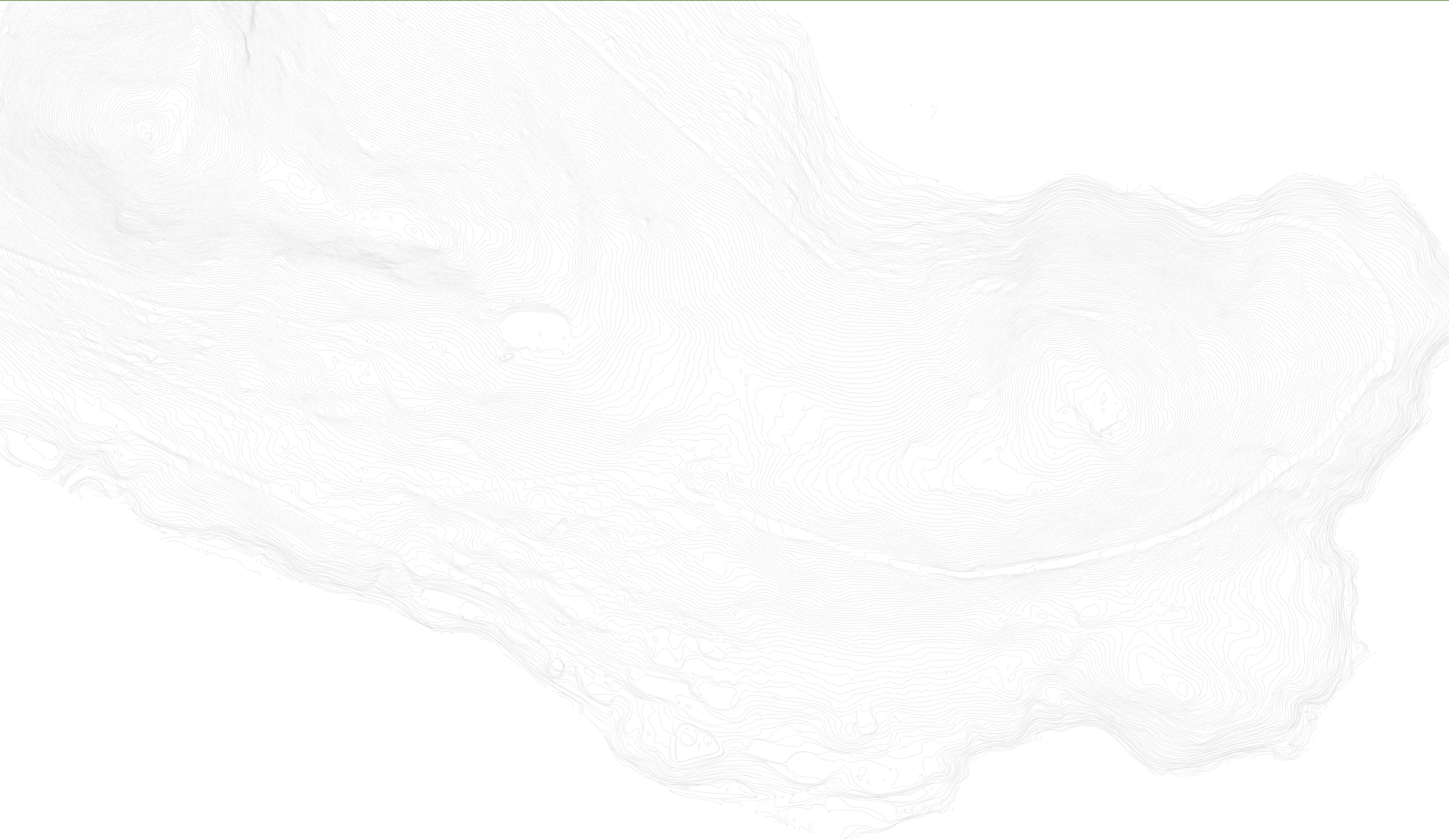

APPENDIX 2
ANALYSIS OF COMMUNITY + STAKEHOLDER ENGAGEMENT

DRAFT

